

The ZBC is a donut load cell specially designed for the measurement compressive/tension forces and weight. Low form factor allows to use it in applications where there is little space for the load cell, such as bolt compression and tension measurements.



**FEATURES**

- Capacities 75 & 100klbs
- Environmental protection IP67
- Stainless Steel construction

**APPLICATIONS**

- Tension/Compression
- Force measurement
- Weight measurement

**OPTION**

- Cable - open or connector

**OUTLINE DIMENSIONS**

**Connector Version**

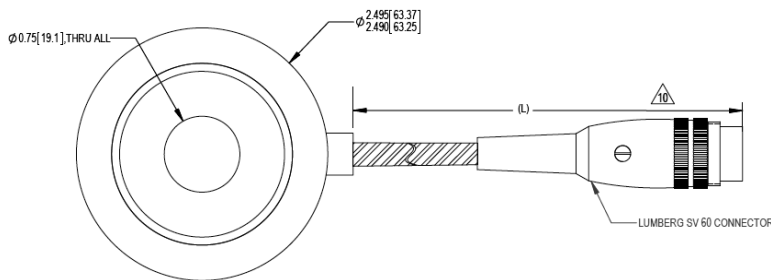

**Open Cable Version**

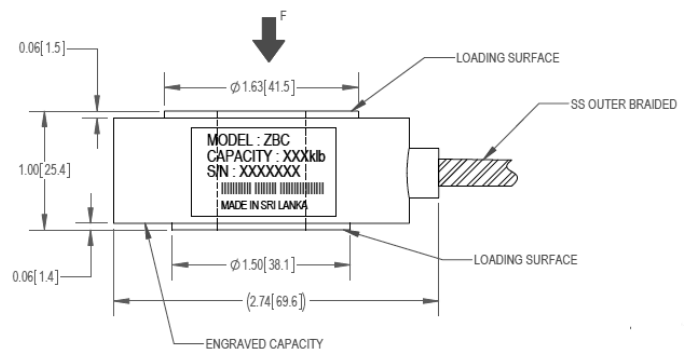
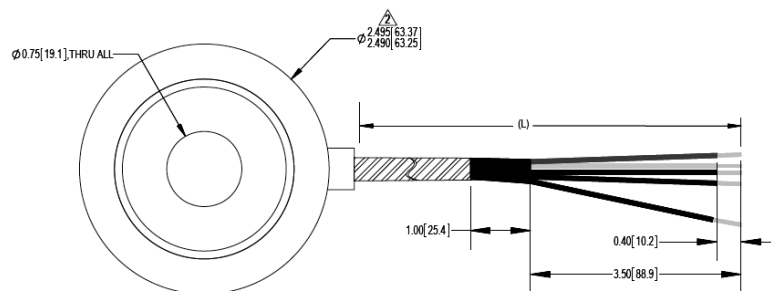

## SPECIFICATIONS

Model	ZBC	
Capacity	klb	75, 100
Full Scale Output (FS)	mV/V	2.0±10%
Non-linearity	%FS	≤±1
Hysteresis	%FS	≤±1
Non-repeatability	%FS	≤±0.1
Creep @30min	%FS	≤±0.1
Zero Balance	%FS	≤±5
Temperature Range		
Compensated	°C	-10...+40
Operating	°C	-20..+80
Temperature Effect		
Output	%FS/10°C	≤±0.09
Zero	%FS/10°C	≤±0.09
Terminal Resistance		
Input	Ω	386±30
Output	Ω	359±5
Excitation Voltage	VDC	5 ~ 15
Insulation Resistance @50VDC	M Ω	≥5000
Safe Overload Limit	%FS	150
Ultimate Load	%FS	200
Seal Type IP67		
Cable Length (L)	m	3 <sup>+0.1</sup> <sub>-0</sub>
Cable Type 24 AWG 4 Core Braided TPR Black Cable		
Element Material Stainless Steel		

## WIRING GRAPHIC

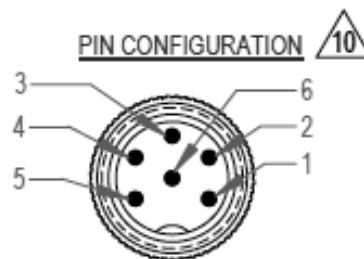
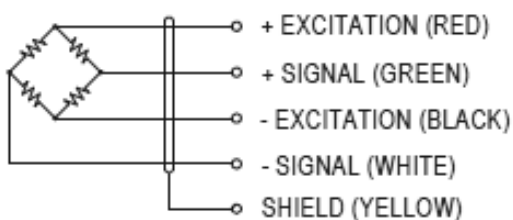

Pin	Configuration
1	+ Excitation
2	- Excitation
3	+ Signal
4	- Signal
5	N/A
6	N/A

## PART NUMBER

### Open Cable

Capacity (lb)	Group Four Part Number
75,000	5051-000-01
100,000	5051-001-01

### Connector Version

Capacity (lb)	Group Four Part Number
75,000	5051-000-00
100,000	5051-001-00