

The SSLM is a compression ring type donut shape load cell. Its application ranges from force measurement, weight measurement, tank weighing, hopper weighing, cable tension measurement, bolt compression force and other industrial measurement applications.



### FEATURES

- Capacity: 25 & 55 ton
- Stainless Steel construction
- Environmental Protection IP69
- Low-profile design

### APPLICATIONS

- Force Measurement
- Tank weighing
- Silo weighing
- Hopper weighing
- Weighbridges

### DIMENSIONS

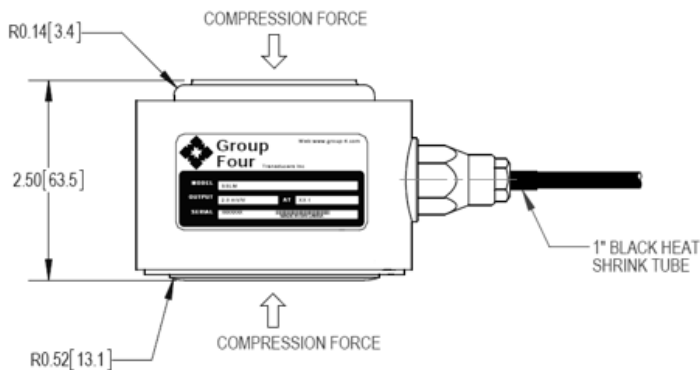
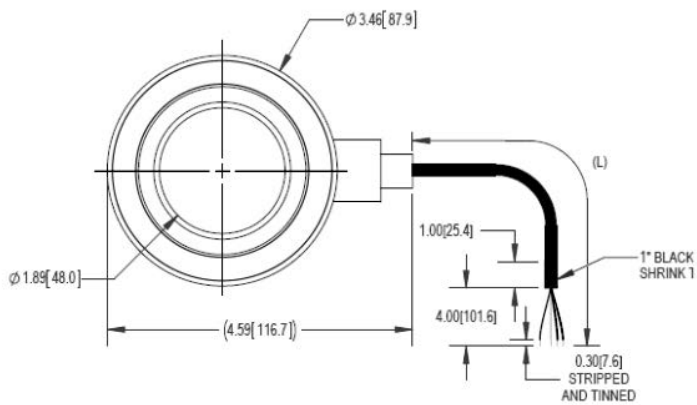

## SPECIFICATIONS

Model	SSLM	
Capacities	t	25, 55
Full Scale Output (FS)	mV/V	2.0± 0.5
Zero Balance	mV/V	≤±1
Non-Linearity	%FS	≤±0.5
Hysteresis	%FS	≤±0.5
Creep @30min	%FS	≤±0.03
Temperature Effect (output)	%FS/10C	≤±0.4
Temperature Effect (zero)	%FS/10C	≤±0.4
Temperature Range (compensated)	C	-10~ +40
Temperature Range (operated)	C	-20~ +65
Terminal Resistance (input)	Ω	736±30
Terminal Resistance (output)	Ω	700±5
Excitation Voltage	VDC	5~15
Insulation Resistance @50VDC	MΩ	>5000
Safe Overload Limit	%FS	150
Cable Length	ft	10 <sup>+0.02</sup> <sub>-0</sub>
Cable Type	22 AWG 4 CONDUCTOR BLACK SHIELD CABLE	
Seal Type	IP69	
Element Material	Stainless Steel	
Zero Balance	mV/V	≤±1

## WIRING

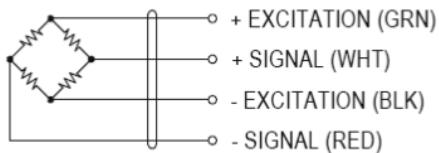

## PART NUMBERS

Capacity (Kg)	Part Number
25,000	8039-000-00
55,000	8039-001-00